

15W

7 in 1 Foldable 2 Coils

Fast Wireless Charger Stand

User Manual

User Manual

This is an intelligent fast wireless charger stand that allows you enjoy the fun of digital products easily.

Please kindly read the user manual before using and keeping it for future reference.

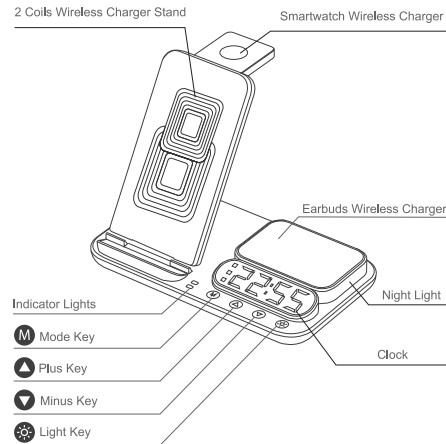

Specification

Input:	DC 12V 3A, 9V 3A, 5V 3A
Output:	
Wireless Charger Stand:	5W/7.5W/10W/15W (Max)
Smartwatch Stand:	2.5W (Max)
Wireless Charger Pad:	5W (Max)
USB A Output:	5V 2A
Charging Frequency:	110-205KHZ
Power Conversion:	≤80%
Charging Distance:	4-10mm
Wireless Charging Standard:	Qi

Time / Alarm Clock / Night Light Setting

M Mode key function:

- Short press **M** key: Switchover the 12 hours time system or 24 hours time system on the clock's display screen.
- Long press **M** key: Enter time setting mode.
- Double click **M** key: Enter alarm clock setting mode.

A Plus key function:

- Short press **A** key: The hour or minute on the clock's display screen will be added 1 while enter time setting or alarm clock setting mode.
- Long press **A** key: The alarm clock function will be disabled on the first time long press; The alarm clock function will be recovered on the second time long press.

- Can press any key to turn off the alarm clock when it rings.

V Minus key function:

- Short press **V** key: The hour or minute on the clock's display screen will be reduced 1 while enter time setting or alarm clock setting mode.
- Long press **V** key: No any reaction.

Light key function:

- Short press **Light** key: White light will be lighted up on the first time short press; Warm white light will be lighted up on the second time short press; White light and warm white light will be lighted up together on the third time short press; The light will be turned off on the forth time short press.
- Long press **Light** key: The brightness of the night light will be reduced on the first time long press; The brightness of the night light will be increased on the second time long press.
- Double click the **Light** key: Can turn on/off the clock's display screen.

Connect to Power Adapter

QC3.0 Power Adapter/
36W PD Power Adapter

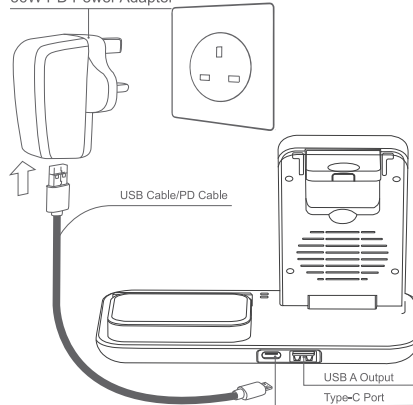

- ① Connect the power adapter to socket.
- ② Connect adapter to the USB 2.0 interface, the other Type-C to pad.
- ③ Connect to the power supply, the indicator lights will turn to solid green, enter standby mode.

Note: Fast wireless charging requires QC 3.0/36W PD fast power adapter. You need to buy power adapter separately.

Charging Mode

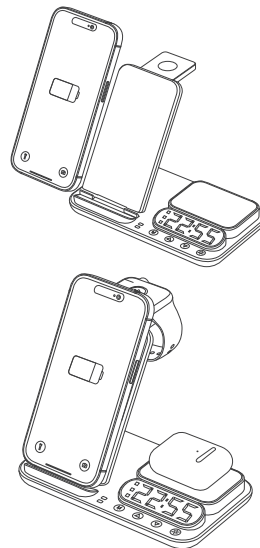

1. Connect to the power supply, the indicator lights will turn to solid green, enter standby mode.
2. Put a Qi-enabled phone on the charger stand, the front green indicator light will turn to solid blue, it shows the phone start wireless charging. When the phone removed from the charger stand, this blue indicator light will turn to solid green, enter standby mode.
3. Put a Qi-enabled earbuds on the earbuds wireless charger, the rear green indicator light will turn to solid blue, it shows the earbuds start wireless charging. When the earbuds removed from the earbuds wireless charger, this blue indicator light will turn to solid green, enter standby mode.
4. Put a Qi-enabled smartwatch on the smartwatch wireless charger, the smartwatch will start wireless charging.
5. Adjustable design: you can adjust the charger stand with different angles.

Attention

- Make sure that the devices are Qi-enabled.
- Make sure that the charging pad is connected to a working power outlet.
- Make sure that you use the proper QC 3.0/36W PD or above fast power adapter.
- Make sure the cellphone case is not thicker than 4mm.
- Make sure that the center of cellphone is pointed to the wireless charging position.

- Make sure that there are no other objects on the charging pad.
- Make sure there's no metal or magnetic material in the center of your cellphone case.

Notes

1. Do not squeeze or collisions.
 2. Do not disassemble or throw into fire or water, to avoid causing a short circuit leakage.
 3. Do not use wireless charger in severely hot, humid or corrosive environments, to avoid circuit damage and occurs leakage phenomenon.
 4. Do not place too close with magnetic stripe or chip card (ID card, bank cards, etc.) to avoid magnetic failure.
 5. Please keep the distance at least 20cm between implantable medical devices (pacemakers, implantable cochlear, etc.) and the wireless charger, to avoid potential interference with the medical device.
- * The involved images are sketch maps, the final product as per the material subjects.

What's in the Box

1. Fast Wireless Charger Stand
2. Type-C Fast Charging Cable
3. User Manual